

Ashwood Road 2-pk Dining Chairs Stock # BH12-093-001-12

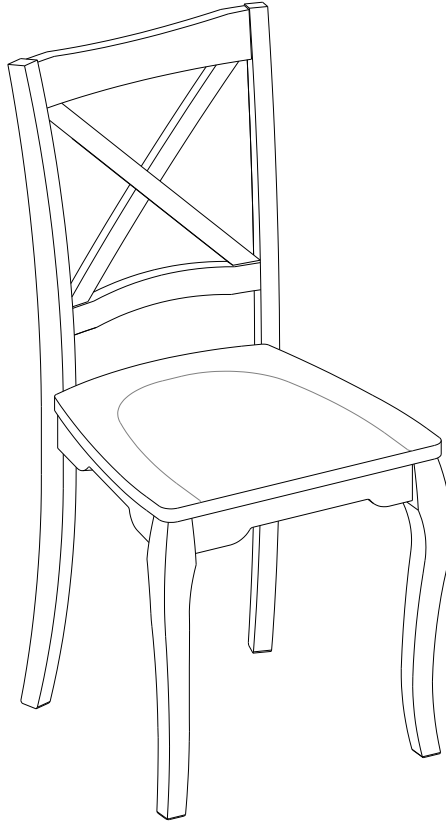

ADULT ASSEMBLY REQUIRED

If you have any questions regarding assembly or if parts are missing, DO NOT return this item to the store where it was purchased. Please call our customer service number and have your instructions and parts list ready to provide the model name, part name or factory number:

1-866-942-5362

Pacific Standard Time: 8:30 a.m. - 4:30 p.m., Monday - Friday

Or visit our website 24 hours a day, 7 days a week for product assistance at

www.whalenstyle.com

Or e-mail your request to **parts@whalenfurniture.com**

**THIS INSTRUCTION BOOKLET CONTAINS IMPORTANT SAFETY INFORMATION.
PLEASE READ AND KEEP FOR FUTURE REFERENCE.**

QUALITY GUARANTEE

We are confident that you will be delighted with your Whalen Furniture purchase.

Should this product be defective in workmanship or materials or fail under normal use, we will repair or replace it for up to one (1) year from date of purchase. Every Whalen Furniture product is designed to meet your highest expectations. We guarantee that you will immediately see the value of our fine furniture.

This warranty gives you specific legal rights and you may also have other rights which vary from State to State.

Customer Service: 1-866-942-5362

8:30 a.m. - 4:30 p.m. PST, Monday to Friday

www.whalenstyle.com

MAXIMUM RECOMMENDED WEIGHT LOADS

1. Maximum load weight is 300 pounds (136.1 kg).



WARNING

THIS UNIT IS INTENDED ONLY FOR USE WITHIN THE MAXIMUM WEIGHTS INDICATED. USE WITH HEAVIER THAN THE MAXIMUM WEIGHTS INDICATED MAY RESULT IN INSTABILITY CAUSING POSSIBLE INJURY.

GENERAL INFORMATION, TIPS and TRICKS

1. Please read the Assembly Instructions prior to assembling the unit.
2. To avoid damage, assemble the unit on a sturdy, level and non-abrasive surface.
3. Keep all hardware part out of reach of children.
4. Please wait until all steps are completed before tightening bolts.
5. Make sure all bolts are tightly fastened before the unit is used.

Please call for replacement parts or assistance: 1-866-942-5362

Whalen Furniture Mfg., Inc.

Page 2

Factory # 15991

Parts and Hardware List

Please read completely through the instructions and verify that all parts listed are present before beginning assembly.

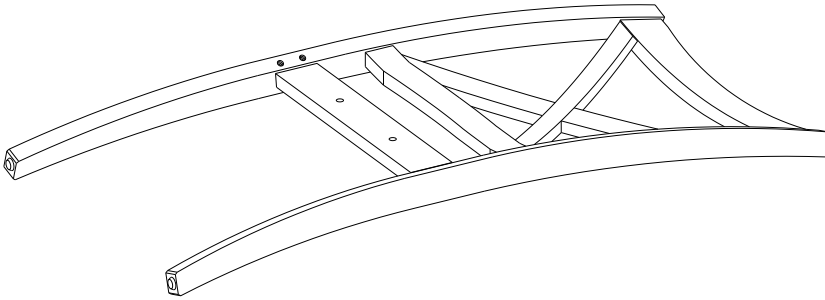

A- CHAIR BACKREST (2)

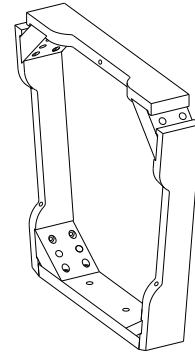

B- SEAT FRAME (2)

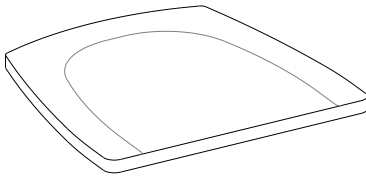

C- SEAT BOARD (2)



D- FRONT LEG (4)

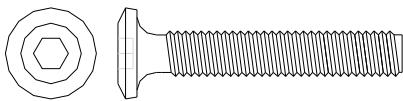

(1) M6 x 35 mm BOLT (4+1 extra)

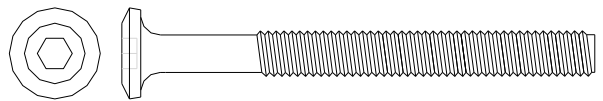

(2) M6 x 60 mm BOLT (8+1 extra)

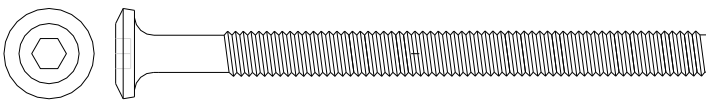

(3) M6 x 75 mm BOLT
(8+1 extra)



(4) M6 LOCK WASHER
(20+1 extra)

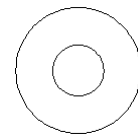

(5) M6 FLAT WASHER
(20+1 extra)



(6) M4 x 38 mm SCREW (10+1 extra)

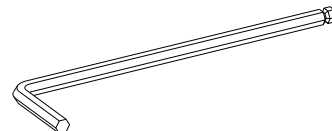

M4 ALLEN KEY (2)

Tools required: Allen Key (provided) and Phillips Screwdriver (not provided).

Assembly Instructions

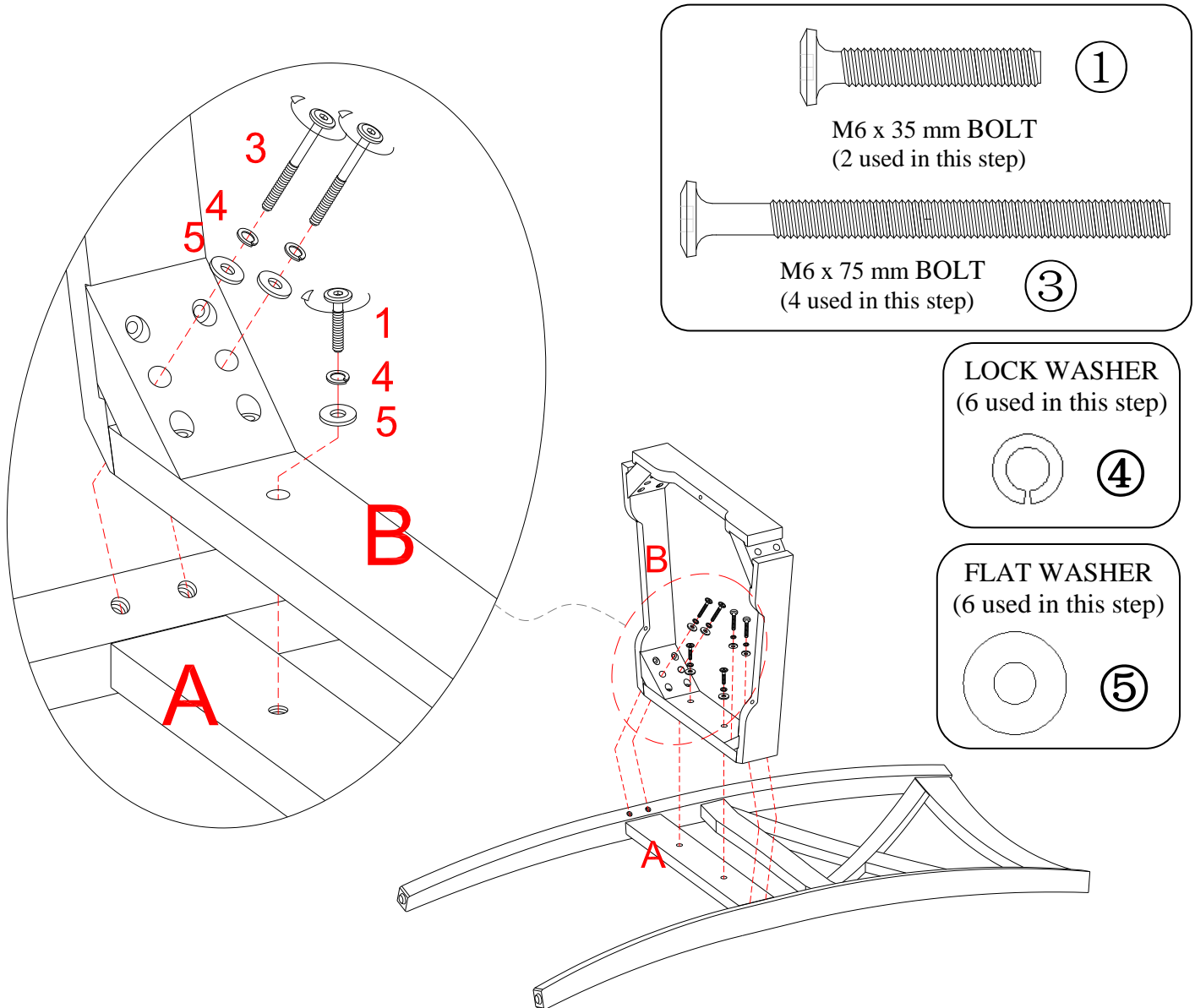

1. Unpack the unit and confirm that you have all the hardware and required parts listed.
2. Lay a CHAIR BACKREST (A) on a smooth and protective surface with the threaded inserts facing up.
3. Place SEAT FRAME (B) onto the middle rail of the CHAIR BACKREST (A). Make sure that the counter sunk screw holes on the SEAT FRAME face floor after assembly. Insert and screw the M6 x 75 mm BOLTS (3) with LOCK WASHERS (4) and FLAT WASHERS (5) through the pre-drilled holes on the seat frame at rear corner blocks and loosely tighten into the threaded inserts on the BACKREST.
4. Secure the SEAT FRAME (B) onto the CHAIR BACKREST (A) by inserting two M6 x 35 mm BOLTS (1) with WASHERS (4 & 5) through the pre-drilled holes on the rear rail of seat frame. Tighten the bolts with enclosed ALLEN KEY.

NOTE: DO NOT over-tighten the bolts.

Please call for replacement parts or assistance: 1-866-942-5362

Whalen Furniture Mfg., Inc.

Page 4

Factory # 15991

Assembly Instructions

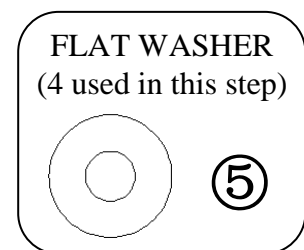
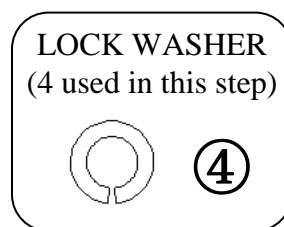
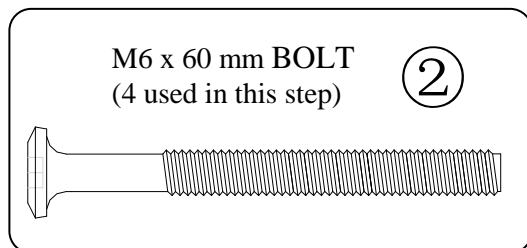
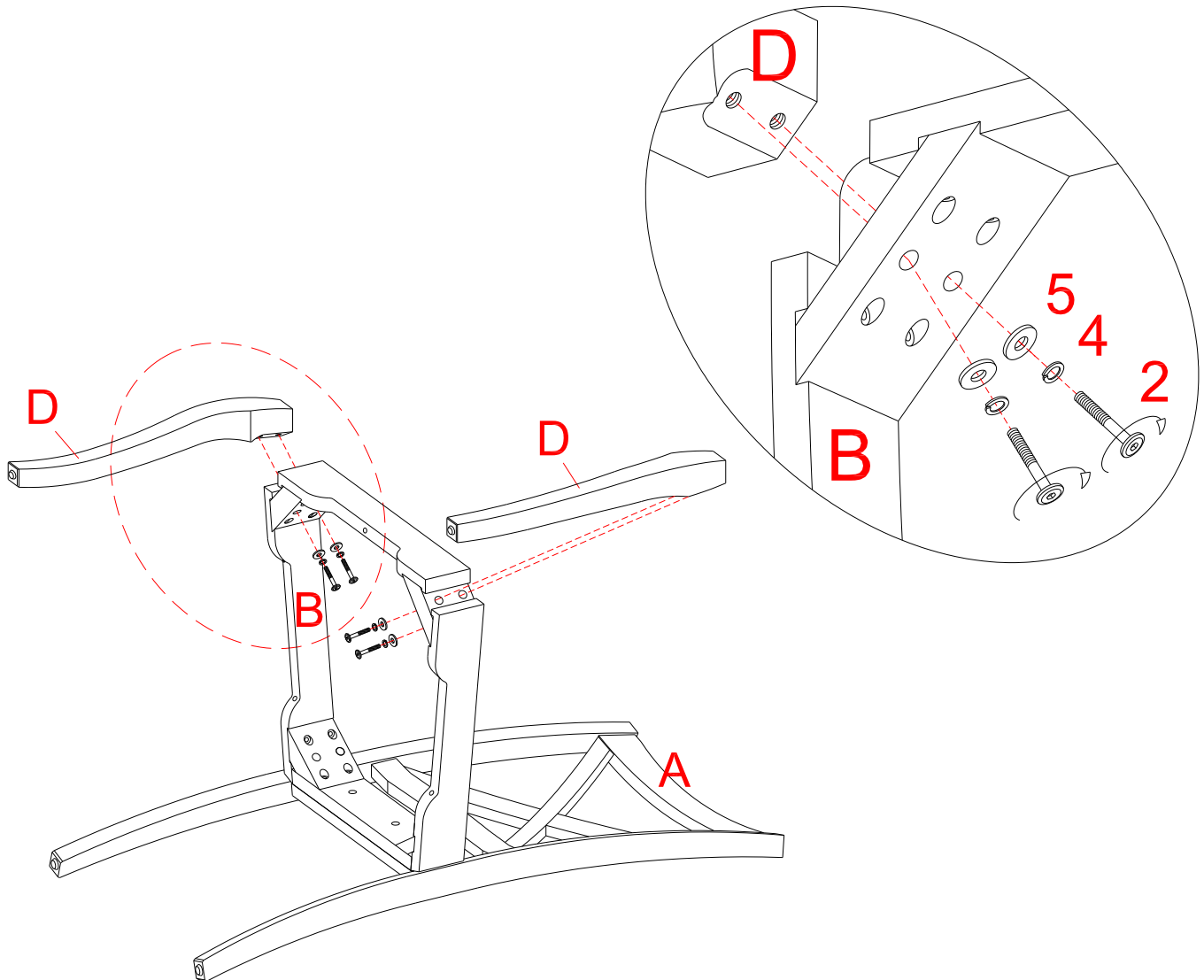

5. Attach two FRONT LEGS (D) to the front corner blocks of SEAT FRAME (B) by inserting M6 x 60 mm BOLTS (2) with WASHERS (4 and 5) through the pre-drilled holes on corner blocks into the threaded inserts on FRONT LEGS. Tighten the bolts with enclosed ALLEN KEY.

NOTE: DO NOT fully tighten all the bolts until the chair been adjust and level all the legs so that they do not wobble. Once adjusted then go back and tighten while making sure that the unit remains level.

6. Stand assembled chair upright on a flat surface. Press down SEAT FRAME (B) to even all legs. Now tightly fasten all bolts with enclosed Allen Key.

Please call for replacement parts or assistance: 1-866-942-5362

Whalen Furniture Mfg., Inc.

Page 5

Factory # 15991

Assembly Instructions

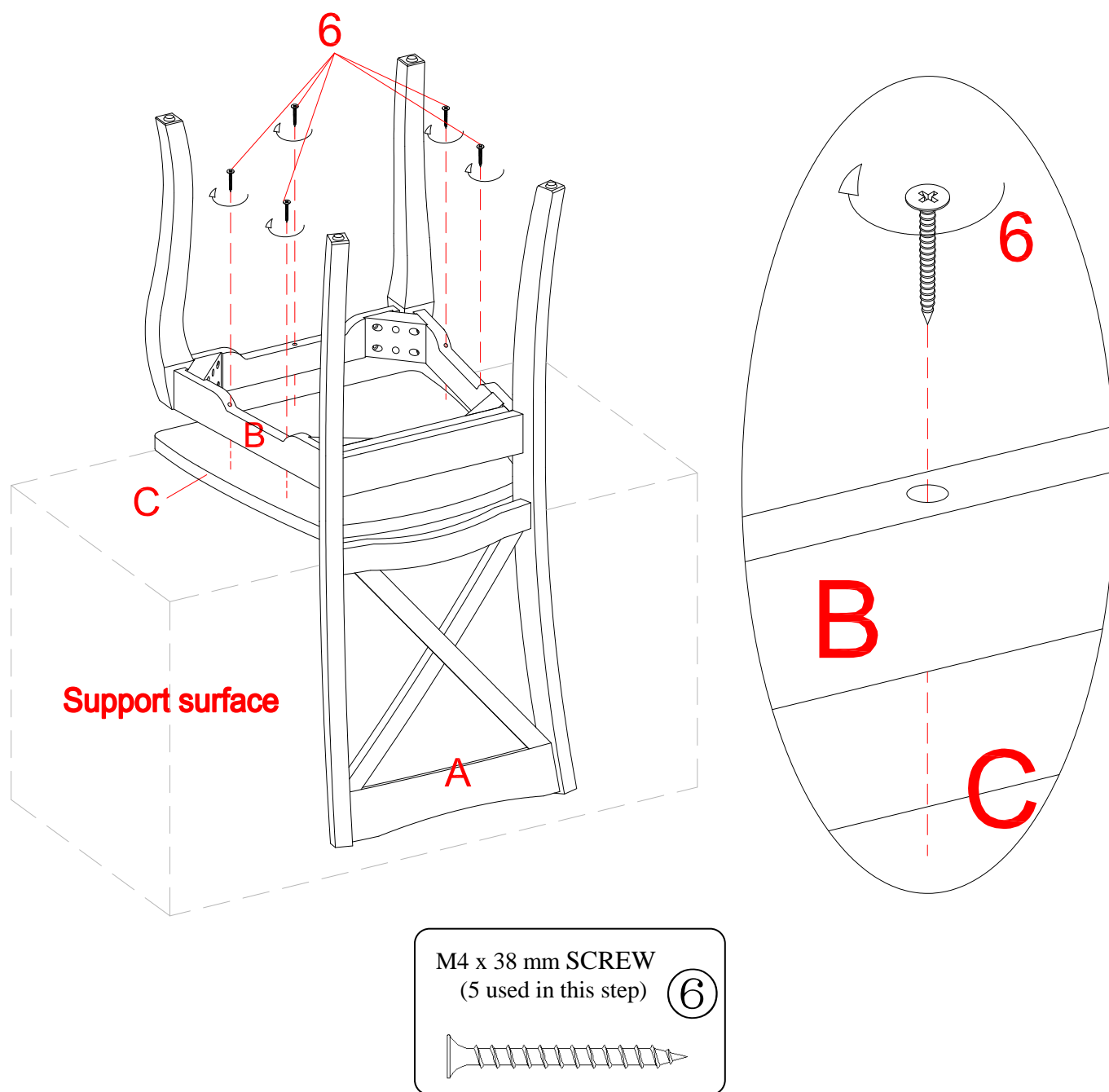

7. Flip assembled chair upside down and attach to the bottom of SEAT BOARD (C) making sure it is centered properly. Secure the SEAT BOARD in place by inserting five M4 x 38 mm Screws (6) into the countersunk holes on SEAT FRAME (B). Tighten the screws with a Phillips Screwdriver.
8. Stand the chair upright
9. Repeat the process to assemble the other Chair.

Care and Maintenance

- From time to time please ensure there are no loose nuts on the product.
- Use a soft, clean cloth that will not scratch the surface when dusting.
- Use of furniture polish is not necessary. Should you choose to use polish, test first in an inconspicuous area.
- Using solvents of any kind on your furniture may damage your furniture's finish.
- Never use water to clean your furniture as it may cause damage to the finish.
- Always use coasters under beverage glasses and flowerpots.
- Liquid spills should be removed immediately. Using a soft clean cloth, blot the spill gently. Avoid rubbing.
- Always use protective pads under hot dishes and plates. Heat can cause chemical changes that may create spotting within the furniture finish.
- Stains or marks from crayons or ink markers will be difficult to remove.
- In the event that your furniture is stained or otherwise damaged during use, we recommend that you call a professional to repair your furniture.
- Check bolts/screws periodically and tighten them if necessary.

Further advice about wood furniture care

It is best to keep your furniture in a climate-controlled environment. Extreme temperature and humidity changes can cause fading, warping, shrinking and splitting of wood. It is advised to keep furniture away from direct sunlight as sun may damage the finish.

Proper care and cleaning at home will extend the life of your purchase. Following these important and helpful tips will enhance your furniture as it ages.

We hope you enjoy your purchase for many years.
Thank you for your purchase!

**Better
Homes
and Gardens.**

IF YOU NEED TO ORDER PARTS PLEASE USE THE LIST BELOW
Ashwood Road 2-pk Dining Chairs (BH12-093-001-12)

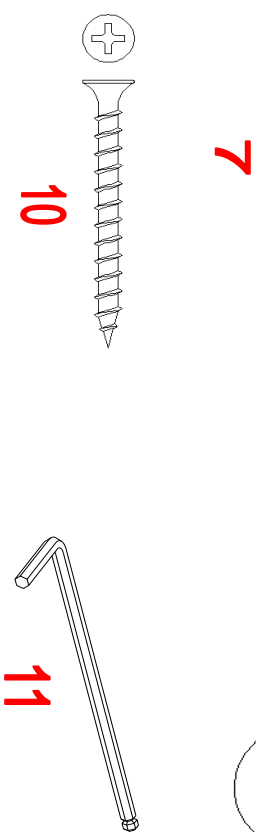
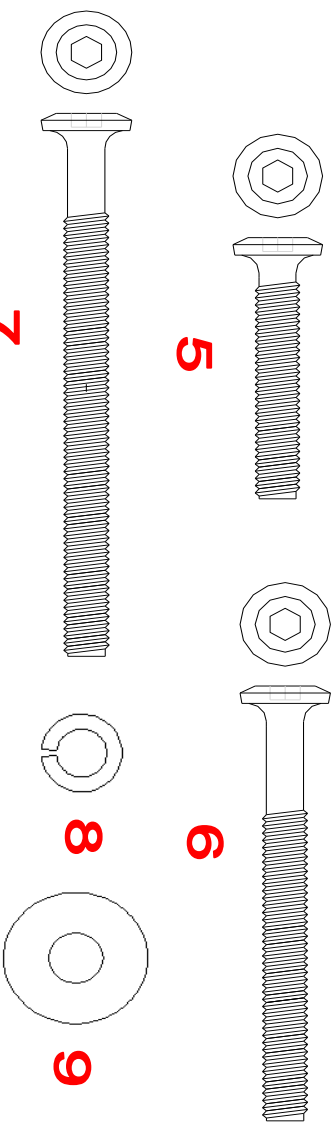
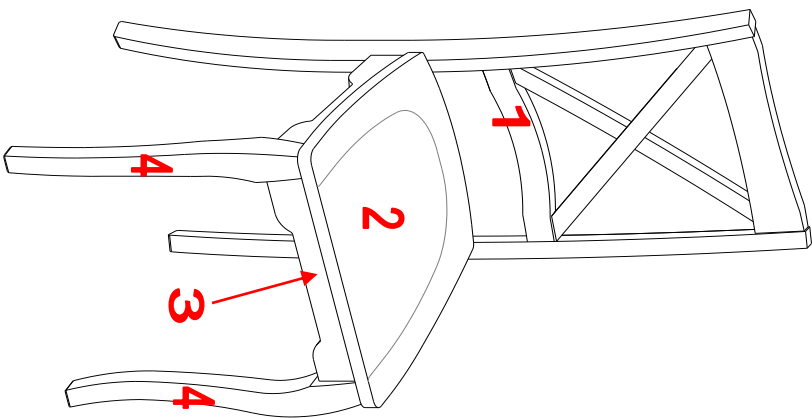

*BH12-093-001-12-1-CB
*BH12-093-001-12-2-SB
*BH12-093-001-12-3-SF
*BH12-093-001-12-4-FL
*BH12-093-001-12-5-M6x35B
*BH12-093-001-12-6-M6x60B

Chair Backrest
Seat Board
Seat Frame
Front Leg
M6 x 35 mm Bolt
M6 x 60 mm Bolt

*BH12-093-001-12-7-M6x75B
*BH12-093-001-12-8-LW
*BH12-093-001-12-9-FW
*BH12-093-001-12-10-M4x38S
*BH12-093-001-12-11-M4AK
*BH12-093-001-12-CH
M6 x 75 mm Bolt
Lock Washer
Flat Washer
M4 x 38 mm Screw
M4 Allen Key
Complete Hardware